

GL SERIES | GREYWATER FILTERS

A large filtering surface with surge and pressurization capacity make the GL Series Greywater Filters a good choice for a large landscape drip zone with numerous greywater sources. The GL Series also provides numerous pumping pressure models for landscapes with moderate to steep terrain.

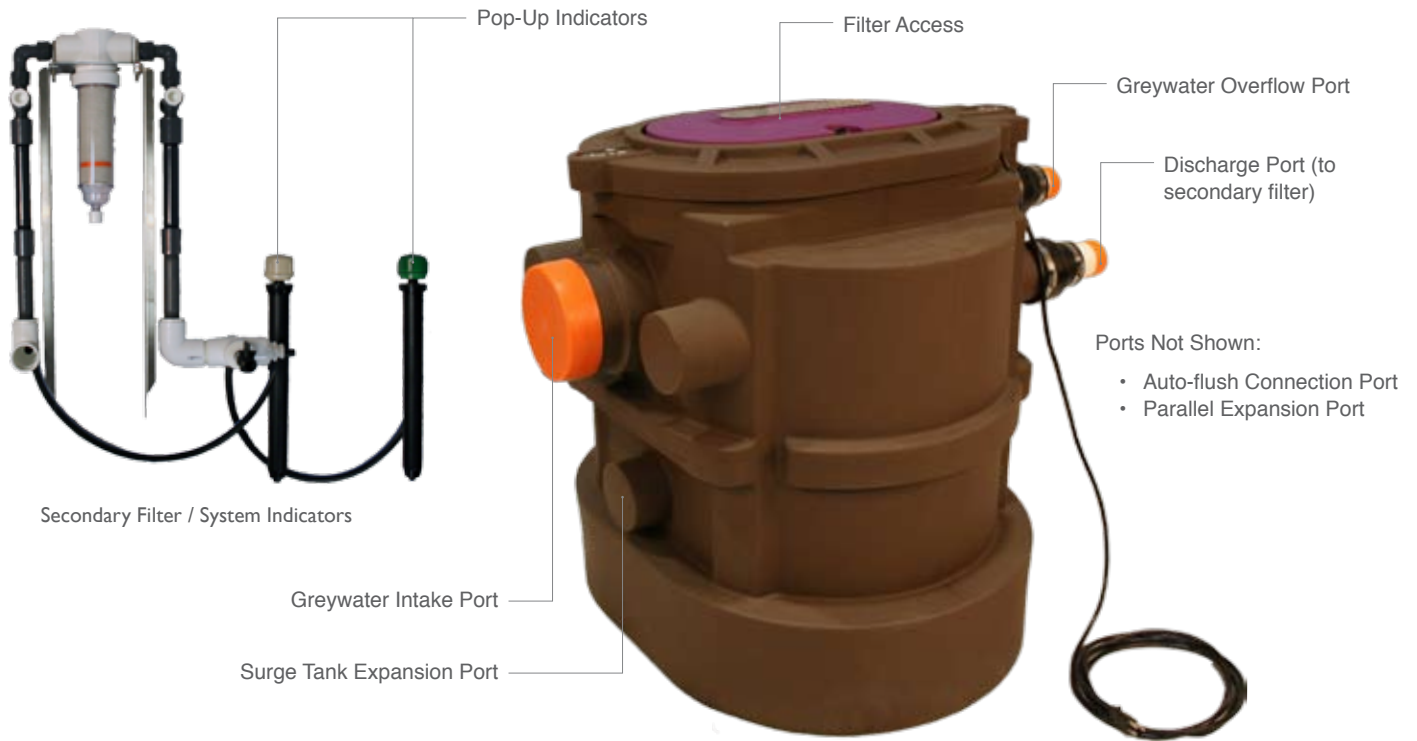

PRODUCT CODE	PUMP	POWER USAGE	TOTAL SURGE CAPACITY (GALLONS)
GL-75-2SP	1/2 HP	115v / 5.5 amp / 650 watt	75
GL-75-3SP	3/4 HP	115v / 8.4 amp / 900 watt	75
GL-75-4SP	1 HP	115v / 9.8 amp / 1100 watt	75
GL-115-2SP	1/2 HP	115v / 5.5 amp / 650 watt	115
GL-115-3SP	3/4 HP	115v / 8.4 amp / 900 watt	115
GL-115-4SP	1 HP	115v / 9.8 amp / 1100 watt	115
GL-155-2SP	1/2 HP	115v / 5.5 amp / 650 watt	155
GL-155-3SP	3/4 HP	115v / 8.4 amp / 900 watt	155
GL-155-4SP	1 HP	115v / 9.8 amp / 1100 watt	155

GREYWATER FIXTURE	SURGE REQUIRED (GALLONS)
Bathroom Sink	.25*
Shower	25*
Washing Machine	25*
Bathtub	50*

* Average usage.



40 Gallon External Surge Tank included with GL-115 & GS-155 models.

GL SERIES GREYWATER FILTERS

FEATURES:

- Weight: 140 lbs
- Dimensions: L: 35", W: 36", H: 32"
- 3" intake port
- Two Stainless Steel 150 Mesh Filter Baskets
- 1/2 HP, 3/4 HP or 1 HP multi-stage pumping
- Large pumping chamber
- Bolt down integrated lid system
- Convenient filter access
- Removable filter carriage
- Surge tank expansion ports for Add-on Surge Tanks
- Includes Secondary Filter & System Indicators

GL SERIES | GREYWATER FILTERS

TECHNICAL SPECIFICATION

MODELS: *GL-75-2SP, GL-75-3SP, GL-75-4SP, GL-115-2SP, GL-115-3SP, GL-115-4SP, GL-155-2SP, GL-155-3SP, GL-155-4SP*

(greywater filter & pumping unit)

The GL Series Greywater Filter shall include two top-access filter baskets with detachable 100 micron (150 mesh) 316 stainless steel filter elements. The Greywater Filter shall feature a removable, integrated filter carriage, providing unobstructed access to the pump chamber. The Filter Carriage shall also include an integrated overflow. The Greywater Filter shall include a self regulating back wash system capable of removing debris from the exterior of the primary stainless steel filter. The Greywater Filter shall include a high-pressure pump capable of producing

at least 75 feet of head and a float switch to control the pumping operation. The Greywater Filter shall include an internal stainless steel support system to ensure that internal components are held securely in place. The Greywater Filter shall include an external 150 mesh secondary filter with dual pop-up performance indicators to allow for optional expansion via 4 module expansion ports. The Greywater Filter shall include 9 internal pipe connection ports. The Greywater Filter shall include a bolted lid with an inner filter element access cap for convenient filter removal.

The Greywater Filter shall provide 75 gallons of built-in surge capacity. The GL-115-2SP, GL-115-3SP, GL-115-4SP, GL-155-2SP, GL-155-3SP & GL-155-4SP Greywater Filters shall include an additional 40 gallon external surge tank which shall feature two 4" integrated connection ports and an air vent located on the top of the unit.

The Greywater Filter shall be manufactured by Flotender, a division of the Filtrific Company LLC, Bellevue Washington.

U.S. Patent: 8,961,782 B2

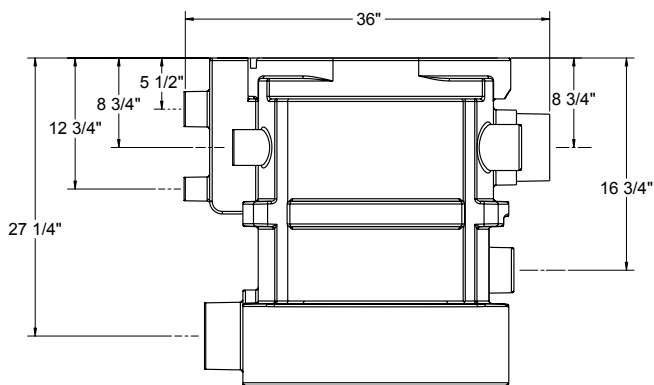

GL SERIES
GREYWATER FILTER - SIDE

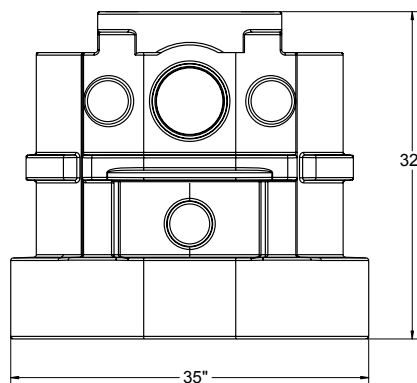

GL SERIES
GREYWATER FILTER - FRONT

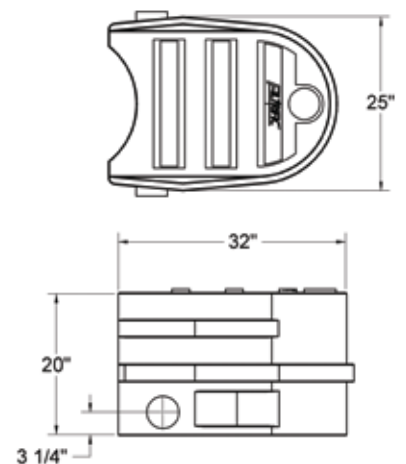

40 GALLON EXTERNAL SURGE
TANK - TOP, SIDE