



Greywater Filtration Systems
for Landscape Irrigation

RESIDENTIAL • COMMERCIAL



flotender™

PRODUCT CATALOG



CONSERVING WITH GREYWATER

Flotender strives to provide customers with the best service and the highest quality greywater filters and components. With a fine attention to detail our products are engineered to support greywater reuse in a variety of drip irrigation applications.

TABLE OF CONTENTS

INTRODUCTION.....	4
GREYWATER FILTERS	
GS Series.....	12
GL Series.....	13
GXL Series.....	14
ADD-ON SURGE TANKS	
STS-40.....	16
STL-165.....	18
PRODUCT DIMENSIONS.....	20
WARRANTY.....	22
NOTES.....	23





REUSING GREYWATER | FOR IRRIGATION

Drip irrigation is the superior method for efficiently distributing greywater to the landscape. Greywater in its raw state is filled with various particulates that will, if unfiltered, quickly clog a drip irrigation system. The Flotender™ Greywater Filter provides advanced mechanical filtration specifically designed to prepare greywater for use with drip irrigation. Through various stages of mechanical filtration all lint, hair, skin particles and other debris is caught in a series of easy-to-clean filters.



ABOVE GROUND OR SUB-SURFACE DRIP IRRIGATION

Flotender's patent pending greywater filter is compatible with both above ground and subsurface drip irrigation systems.



APPLICATIONS | RESIDENTIAL & COMMERCIAL

The Flotender™ Greywater Filter is designed to support a wide range of greywater applications and system sizes. Applications range from a single family residence utilizing a few greywater fixtures to irrigate a garden or small lawn to a full scale commercial building with dozens of greywater fixtures flowing simultaneously into the filter, distributing the water to multiple planters or lawn areas.





1

Water is Captured

Water is captured from various greywater sources and sent to the Flotender™ Greywater Filter.

2

Water is Filtered, Pressurized, & Pumped

When the greywater enters the Flotender™ Greywater Filter, the fine lint and hair is immediately filtered out. The water is then pressurized and pumped into the drip irrigation system.

3

Water is Delivered to the Plants or Lawn

The filtered, pressurized water is then delivered evenly to each drip emitter at the root zone of the plants, lawn or to the desired custom application.

AUTOMATED OPERATION

The Flotender™ Greywater Filter is fully automated. When greywater enters the system it is automatically filtered, pressurized, and pumped to the above ground or subsurface drip irrigation system. When the water drops to the designated minimum pumping level the system shuts off until the next inflow of greywater.

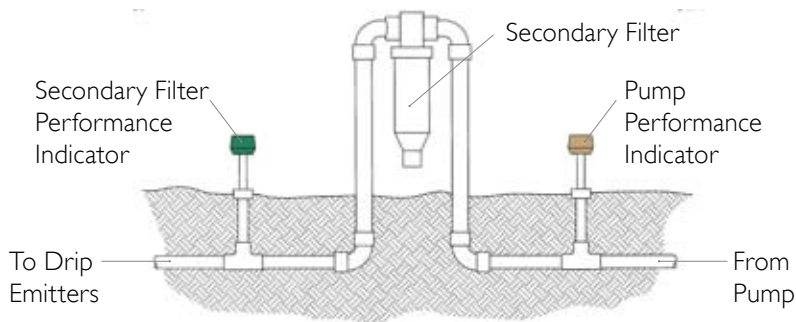

PERFORMANCE INDICATORS

Performance indicators pop-up when the system is pumping and pressurized. The tan indicator signals that the pump is running. The green indicator signals that the secondary filter is operating and the drip system is pressurized.

ONE CONCEPT, THREE SERIES

Each of Flotender's three series of Greywater Filters contain the same components: the Access Cap, Filter Baskets, Bolt Down Lid, Filter Carriage, Spray Ring, High Pressure Pump, Pump Switch and the Polyethylene Housing. Certain specifications vary by model, but the mechanics and engineering remain constant. Precise greywater filtration, expandable surge capacity, automated operation and high pressure pumping are just a few of the many design and installation advantages unique to the Flotender Greywater Filter.



ACCESS CAP WITH COMPRESSION LATCH
Provides easy access to the filters without removing the bolt down lid

FILTER BASKET
Features a detachable 150 mesh filter element

BOLT DOWN LID
The two piece lid system allows the Filter Baskets to be removed without having to remove the entire lid

FILTER CARRIAGE
Supports the Filter Basket and is easily removed to allow complete access to the pumping chamber

SELF REGULATING BACKWASH SYSTEM
Provides multi-point rotary spray to the greywater filter elements ensuring that water flows freely through the filter element

GREYWATER FILTER TANK
The heavy-duty polyethylene tank provides a sturdy housing for the elements and pumping equipment

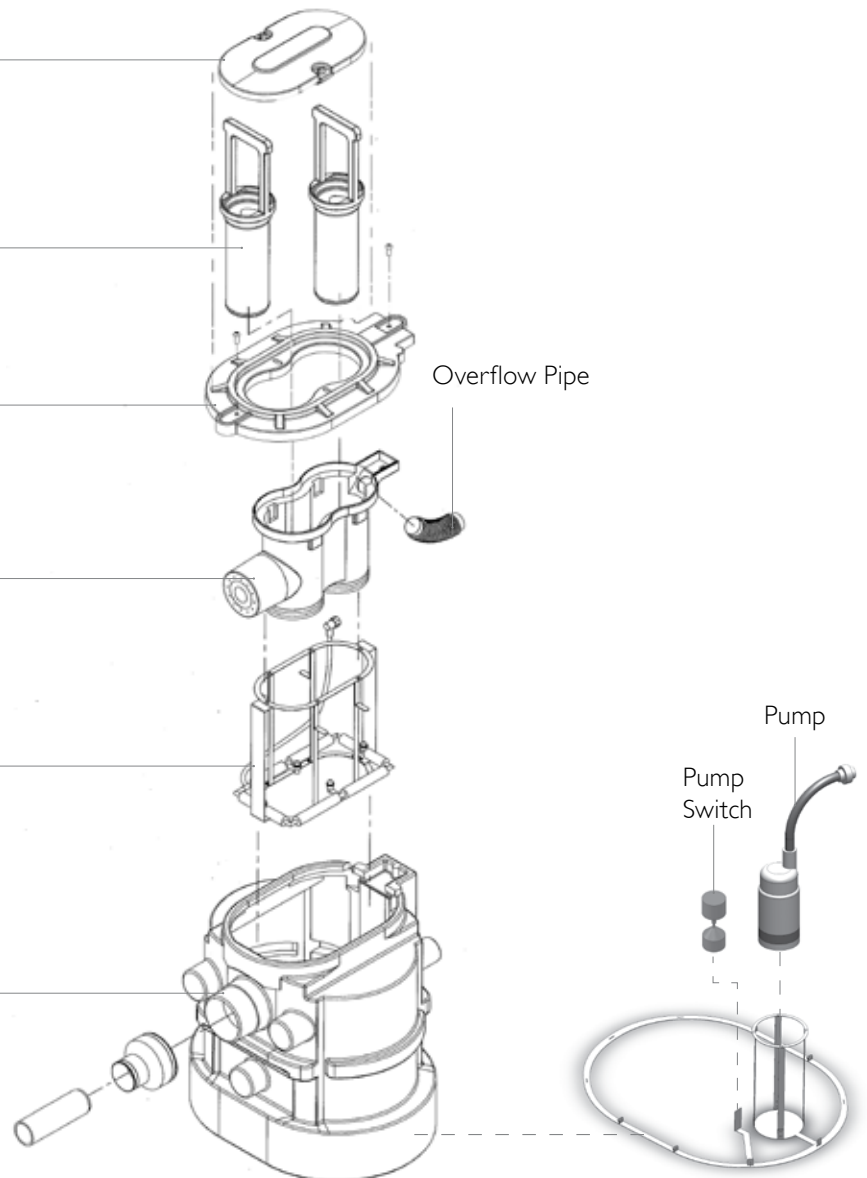

GREYWATER FILTERS | PRECISE FILTRATION

PRECISE GREYWATER FILTRATION

The Flotender Greywater Filter utilizes 150 mesh particle filter baskets for primary greywater filtration. A unique sealing gasket system allows the filter basket to be removed for cleaning and also assures the lint is contained within the filter basket during operation.

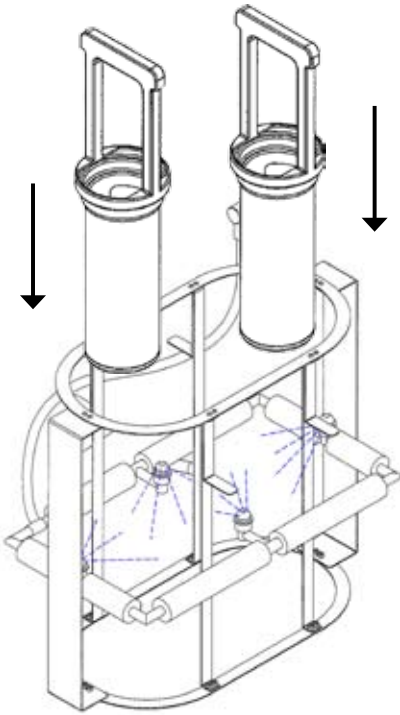

Patent Pending



SELF REGULATING BACK WASH SYSTEM

The Flotender self regulating backwash system prevents lint and other greywater debris from collecting on the inside of the filter basket. The high pressure rotary spray nozzles are mounted on a flotation assembly which allows for constant cleaning at fluctuating water levels.



GS SERIES FILTER ELEMENT

- 1 basket per GS Series Greywater Filter
- Provides 1.7 square feet of surface area



GL SERIES FILTER ELEMENT

- 2 baskets per GL Series Greywater Filter
- Provides 1.7 square feet of surface area



GXL SERIES FILTER ELEMENT

- 2 baskets per GXL Series Greywater Filter
- Provides 3.4 square feet of surface area

SERVICEABILITY

Cleaning the Flotender Greywater Filters is simple and straightforward. Simply open the Access Cap, lift out the basket and wash off the debris.



QUICK-CLEANING

Clean filters are essential in maintaining an efficient greywater filter. Routine maintenance is accomplished by occasionally emptying and cleaning the primary filter. If a large amount of debris has collected in the filter, simply remove the filter element and use a standard garden hose to remove the debris.

SECONDARY FILTER CLEANING

To clean the secondary filter simply unscrew the filter from its casing and clean the element and media with a garden hose.



SECONDARY FILTER

The secondary filter provides a second level of filtration to the Flotender System before the greywater reaches the drip system. It protects against micro lint that may clump together after passing through the filter basket, or any surface debris that could possibly drop into the pumping chamber after removing the filter basket.

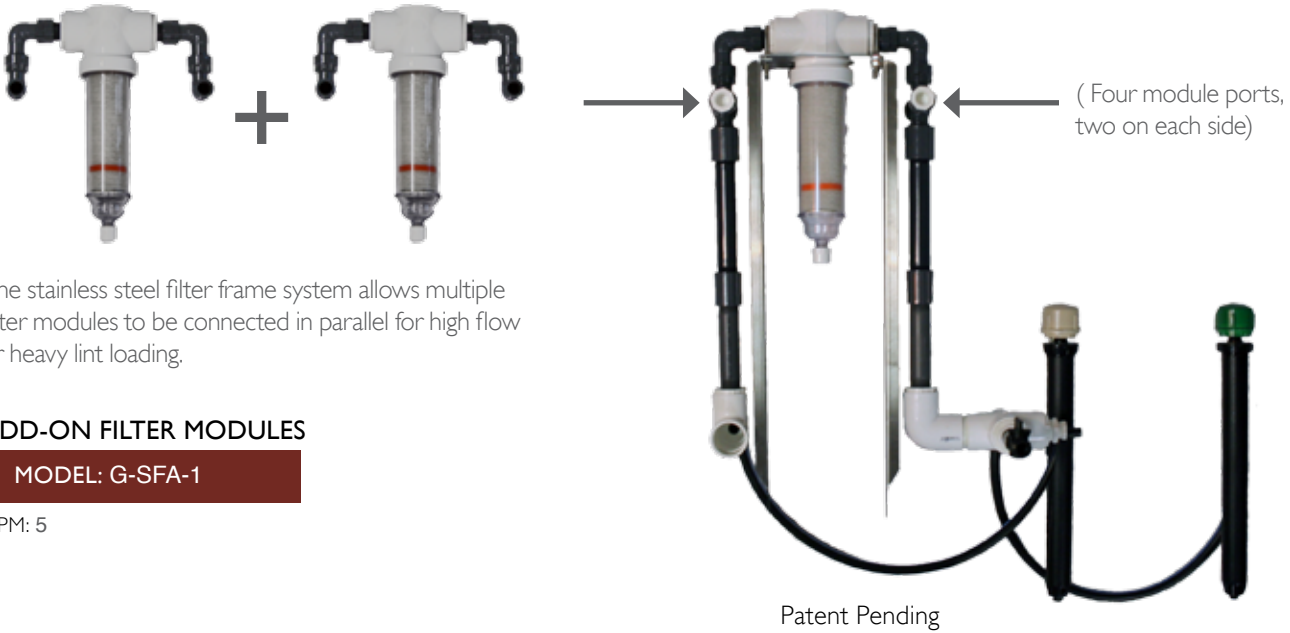

The stainless steel filter frame system allows multiple filter modules to be connected in parallel for high flow or heavy lint loading.

ADD-ON FILTER MODULES

MODEL: G-SFA-1

GPM: 5

HIGH PRESSURE PUMPING

Whether the filtered greywater is to be used to water plants on a flat area, a terraced garden, or to irrigate a lawn via sub-surface irrigation, the built-in Flotender pump is fully capable to get the water where you need it. Refer to the pump curve below for specific detail on the pumping capabilities of the Flotender Greywater Filter.

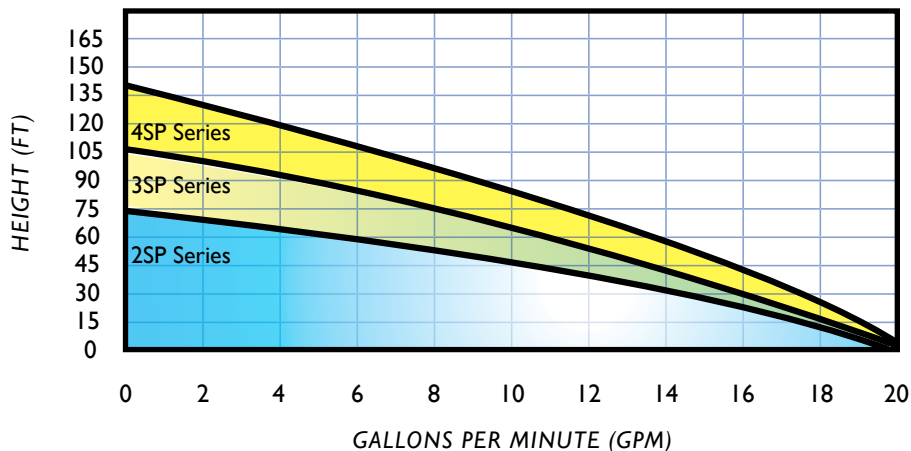

2SP Series: 115v 5.5 amp, 3SP Series: 115v 8.4 amp, 4SP Series: 115v 9.8 amp.

AUTO-FLUSH INTAKE ASSEMBLY

The auto-flush feature allows supplemental watering when on vacation or additional water is needed. Simply design the drip irrigation system, and schedule the irrigation controller to add occasional fresh water to the grey water zone as needed. For larger landscapes with limited grey water sources, grey water is used to offset normal evaporation, while fresh water is used to provide an occasional deep watering.

Patent Pending



To Greywater Filter

In from electric valve



FLOW RESTRICTION DISCS

Interchangeable discs allow for a customized rate of flow into the greywater filter so that the pump out capacity of the filter is not exceeded.

AUTO-FLUSH DEVICE

MODEL: G-AF-1

FEATURES:

- Airgap prevents the chance of back-siphoning into the potable water supply
- Flows up to 5 GPM

EXPANDABLE SURGE CAPACITY

Incorporated into each Flotender Greywater Filter is a specific amount of surge capacity. If more surge capacity is required to accommodate a large number of greywater producing fixtures, additional capacity can be easily installed at the time of the initial installation, or post installation.



GS SERIES | GREYWATER FILTERS

Small in size, but big in performance, the GS series Greywater Filters are perfect for an irrigation drip zone with a limited number of greywater sources.



PRODUCT CODE	PUMP	POWER USAGE	TOTAL SURGE CAPACITY (GALLONS)
GS-40-2SP	1/2 HP	115v / 5.5 amp / 650 watt	40
GS-80-2SP	1/2 HP	115v / 5.5 amp / 650 watt	80

GREYWATER FIXTURE	SURGE REQUIRED (GALLONS)
Bathroom Sink	.25*
Shower	25*
Washing Machine	25*
Bathtub	50*



STS-40 Add-on Surge Tank included with GS-80-2SP.
For more information see page 16

* Average usage.

GS SERIES GREYWATER FILTERS

FEATURES:

- Weight: 105 lbs
- Dimensions: L: 29", W: 31.75", H: 24"
- 2" intake port
- One Stainless Steel 150 Mesh Filter Basket
- 1/2 HP multi-stage pumping
- Large pumping chamber
- Bolt down integrated lid system
- Convenient 13" diameter filter access
- Removable filter carriage
- Surge tank expansion port for Add-on Surge Tanks
- Includes Secondary Filter & System Indicators

A large filtering surface with surge and pressurization capacity make the GL Series Greywater Filters a good choice for a large landscape drip zone with numerous greywater sources. The GL Series also provides numerous pumping pressure models for landscapes with moderate to steep terrain.

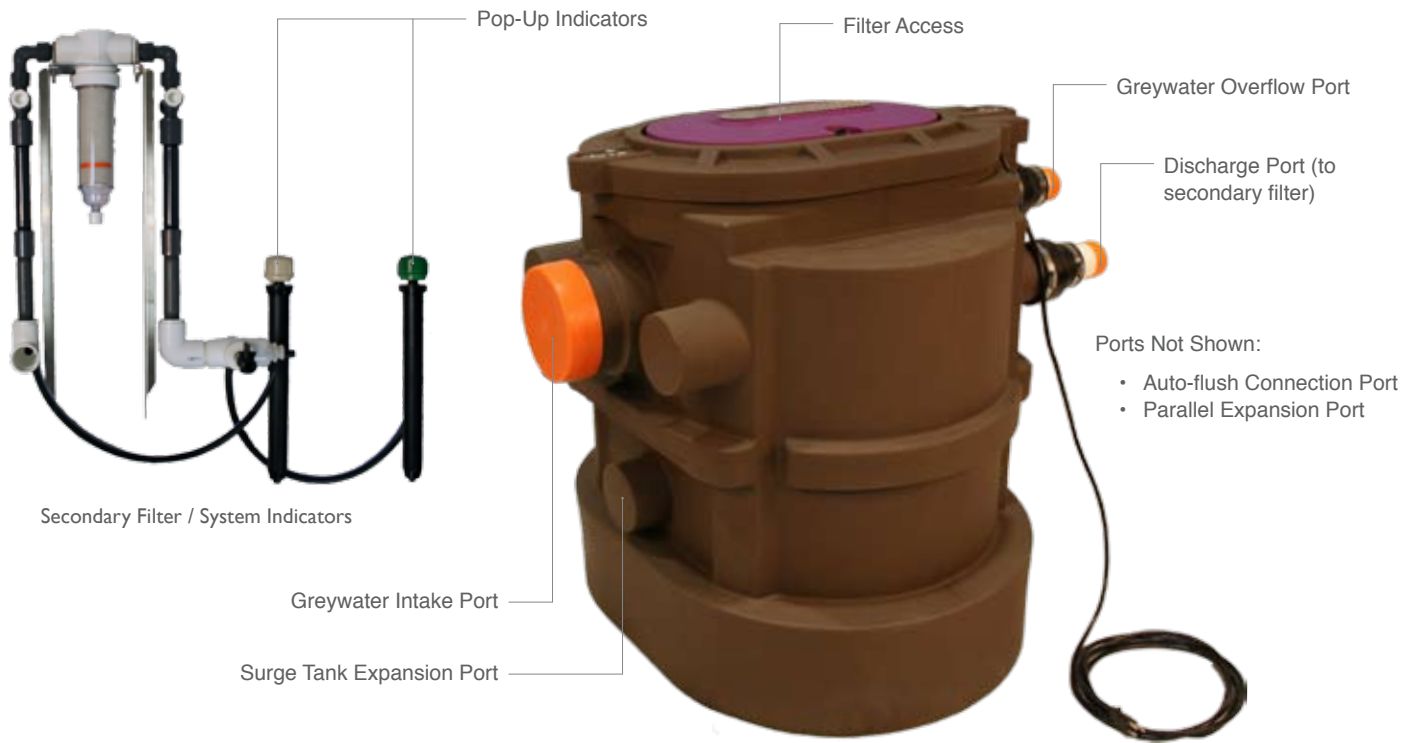

PRODUCT CODE	PUMP	POWER USAGE	TOTAL SURGE CAPACITY (GALLONS)
GL-75-2SP	1/2 HP	115v / 5.5 amp / 650 watt	75
GL-75-3SP	3/4 HP	115v / 8.4 amp / 900 watt	75
GL-75-4SP	1 HP	115v / 9.8 amp / 1100 watt	75
GL-115-2SP	1/2 HP	115v / 5.5 amp / 650 watt	115
GL-115-3SP	3/4 HP	115v / 8.4 amp / 900 watt	115
GL-115-4SP	1 HP	115v / 9.8 amp / 1100 watt	115
GL-155-2SP	1/2 HP	115v / 5.5 amp / 650 watt	155
GL-155-3SP	3/4 HP	115v / 8.4 amp / 900 watt	155
GL-155-4SP	1 HP	115v / 9.8 amp / 1100 watt	155

GREYWATER FIXTURE	SURGE REQUIRED (GALLONS)
Bathroom Sink	.25*
Shower	25*
Washing Machine	25*
Bathtub	50*

* Average usage.



STS-40 Add-on Surge Tank included with GL-115 & GS-155 models. For more information see page 16

GL SERIES GREYWATER FILTERS

FEATURES:

- Weight: 140 lbs
- Dimensions: L: 35", W: 36", H: 32"
- 3" intake port
- Two Stainless Steel 150 Mesh Filter Baskets
- 1/2 HP, 3/4 HP or 1 HP multi-stage pumping
- Large pumping chamber
- Bolt down integrated lid system
- Convenient filter access
- Removable filter carriage
- Surge tank expansion ports for Add-on Surge Tanks
- Includes Secondary Filter & System Indicators

GXL SERIES | GREYWATER FILTERS

The GXL series provides extra large surge and filtering capacity for a landscape requiring a large amount of water and many greywater sources. Several pumping pressure models are listed for landscapes with moderate to steep terrain.

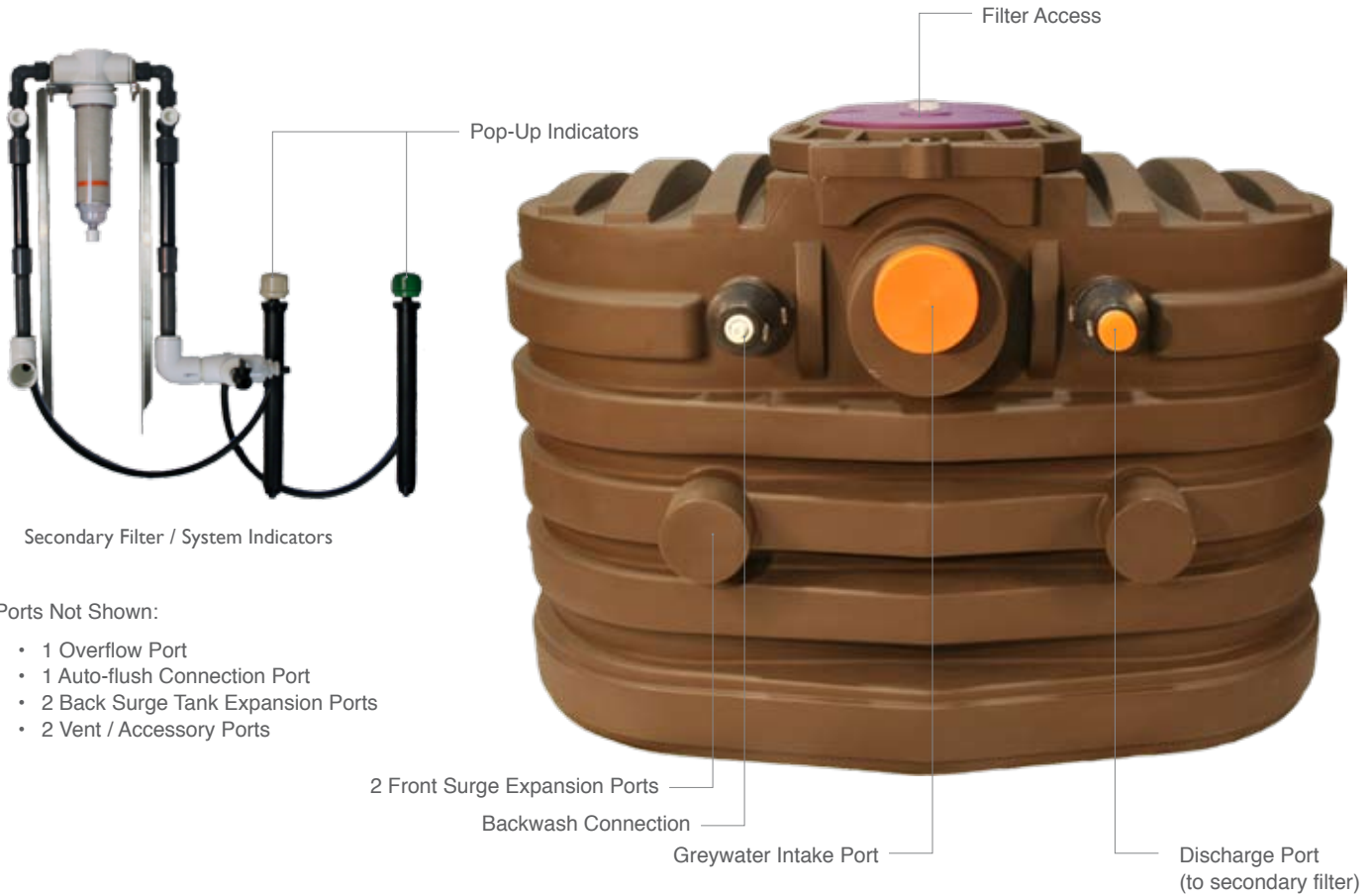

Ports Not Shown:

- 1 Overflow Port
- 1 Auto-flush Connection Port
- 2 Back Surge Tank Expansion Ports
- 2 Vent / Accessory Ports

PRODUCT CODE	PUMP	POWER USAGE	TOTAL SURGE CAPACITY (GALLONS)
GXL-390-2SP	1/2 HP	115v / 5.5 amp / 650 watt	390
GXL-390-3SP	3/4 HP	115v / 8.4 amp / 900 watt	390
GXL-390-4SP	1 HP	115v / 9.8 amp / 1100 watt	390

GREYWATER FIXTURE	SURGE REQUIRED (GALLONS)
Bathroom Sink	.25*
Shower	25*
Washing Machine	25*
Bathtub	50*

* Average usage.



STL -165 Add-on Surge Tanks can be connected for further surge expansion of GXL Series Greywater Filters, For more information see page 18

GXL SERIES GREYWATER FILTERS

FEATURES:

- Weight: 326 lbs
- Dimensions: L: 70", W: 51.5", H: 48"
- 3" Large intake port
- Two Stainless Steel 150 Mesh Filter Baskets
- 1/2 HP, 3/4 HP or 1 HP multi-stage pumping
- Large pumping chamber
- Bolt down integrated lid system
- Convenient filter access
- Removable filter carriage
- Surge tank expansion ports for Add-on Surge Tanks
- Includes Secondary Filter & System Indicators



STS-40 | ADD ON SURGE TANK

The STS-40 Surge Tank fits precisely around either end of both the GS and GL Series Greywater Filters, providing additional surge capacity in confined spaces.

COVER IT UP

- The top of the STS-40 Surge Tank rests below ground level, allowing it to be placed beneath lawn and ground cover.

AIR VENT

- The Air Vent on the STS Surge Tank allows water to flow quickly in and out of the tank



STS-40 SURGE TANK

MODEL: STS-40

WEIGHT: 40 lbs

FEATURES:

- Side-nesting surge tank connects to either side of the GS or GL Greywater Filters
- Adds an additional 40 gallons of water-in-motion reserve when connected to the GL Series Greywater Filters
- Only requires a two foot deep hole
- A 4" connection on both sides for connecting to a Greywater Filter or additional STS Surge Tanks
- Includes vented cap

COMBINATIONS

Placed side-to-side or front to back, the versatility of the STS-40 Series Surge Tank provides numerous placement options in the landscape.



REQUIRES CONNECTION PACK:
 FOR GS SERIES: GRC-44LL
 FOR GL SERIES (SHOWN): GRC-44LL



REQUIRES CONNECTION PACK:
 FOR GS SERIES: GRC-44LTL
 FOR GL SERIES (SHOWN): GRC-44LTL

CONNECTION PACKS

- Included with STS-40 Surge Tank when purchased with a Greywater Filter
- **Not included when purchasing a STS-40 Surge Tank individually**

STS SURGE TANK™ CONNECTION PACKAGE

MODEL: GRC-44LL

INCLUDES:

- 2 - 4" Flex 90
- 1 - 4" x 20" PVC Pipe
- 2 - 4" Flex-Couplings



STS SURGE TANK™ CONNECTION PACKAGE

MODEL: GRC-44LTL

INCLUDES:

- 1 - 4" Flex Tee
- 2 - 4" Flex 90
- 1 - 4" x 31" PVC Pipe
- 3 - 4" Flex-Couplings



STL-165 | ADD ON SURGE TANK

The rugged STL-165 Surge Tank is designed to withstand the most rigorous construction demands encountered in large greywater system installations. Strong horizontal reinforcing ribs interlock with the surrounding soil and securely hold the STL-165 Surge Tank in place during backfill. The STL Surge Tank employs the use of four 6" ports, which easily connect to the GXL Series Greywater Filters. The ports allow the STL-165 Surge Tank to accommodate systems that require a higher surge flow.



STL-165 SURGE TANK

MODEL: STL-165

WEIGHT: 156 lbs

FEATURES:

- Four 6" coupling ports for connection to greywater filters or additional add-on surge tanks
- One 3" vent port
- Adds an additional 140 gallons of water-in-motion reserves when connected to the GXL Series Greywater Filters
- Includes coupling pipe & fittings
- Includes vent cap

SIDE VIEW

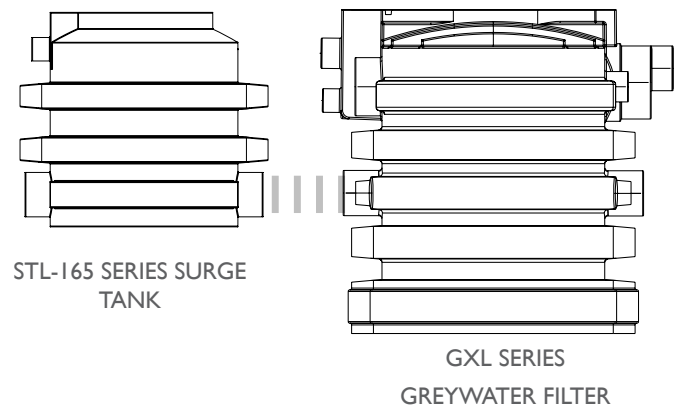

STL-165 SERIES SURGE TANK

GXL SERIES GREYWATER FILTER



AMAZING STRENGTH

Flotender Surge Tanks are manufactured to meet the demands of both residential and commercial installations. The reinforced top allows the tanks to accommodate placement under ground cover, lawn, walkways or beside driveways where occasional vehicular traffic might be encountered.

COMBINATIONS

With two 6" expansion ports on both the front and back sides, the STL-165 Series Surge Tank can be added in numerous combinations and quantities next to, or away from, the GXL Series Greywater Filters. The versatility of the STL-165 Surge Tank makes it easy to add additional expansion as needed. For additional dimensional information see page 21.



GXL Series Greywater Filter Connection Fittings Included with STL-165 Surge Tanks

GXL Series Greywater Filter ▶



STL Series Surge Tank ▶

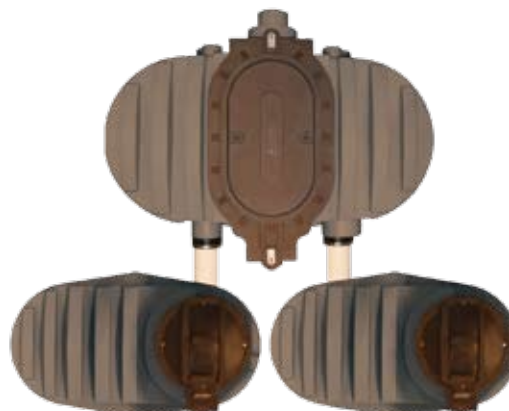

PRODUCT DIMENSIONS |

CAD & SPECIFICATION DOWNLOADS

Visit www.flotender.com for downloadable CAD and specification details.

GS SERIES GREYWATER FILTERS

PAGE: 12

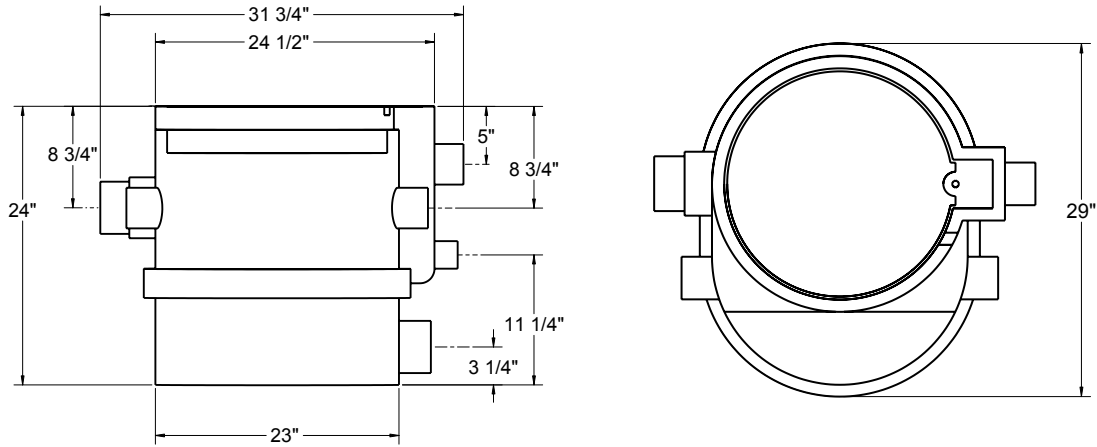

STS-40 SURGE TANK

PAGE: 16

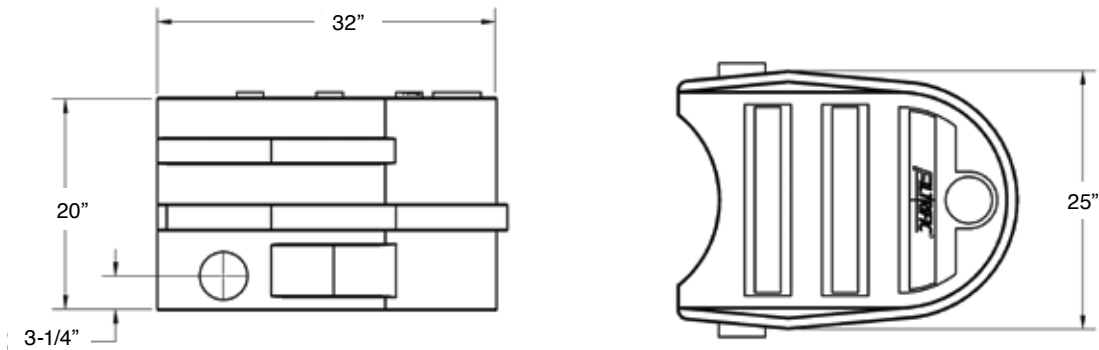

GL SERIES GREYWATER FILTERS

PAGE: 13

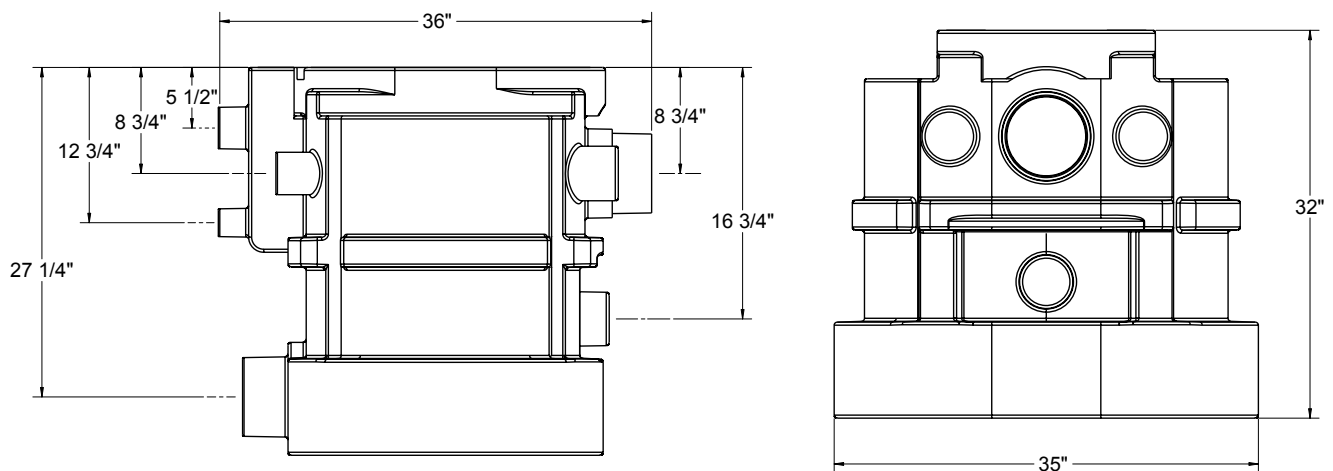

GXL SERIES GREYWATER FILTERS

PAGE: 14

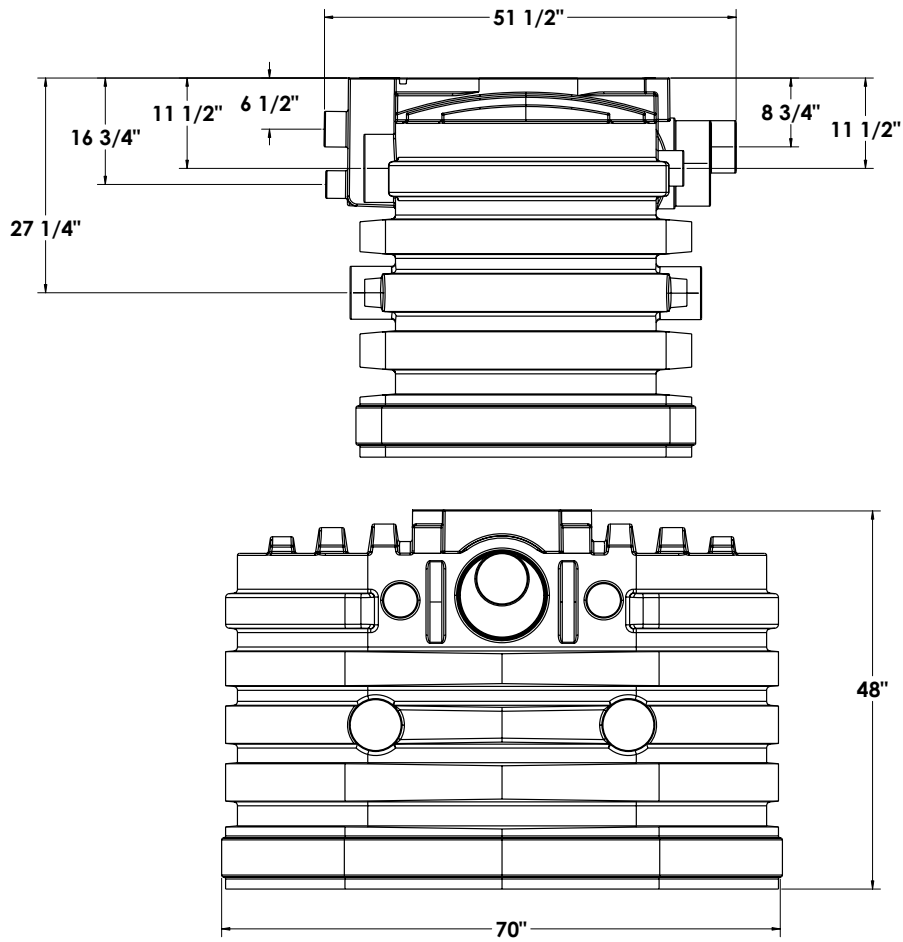

STL-165 SERIES SURGE TANK

PAGE: 18

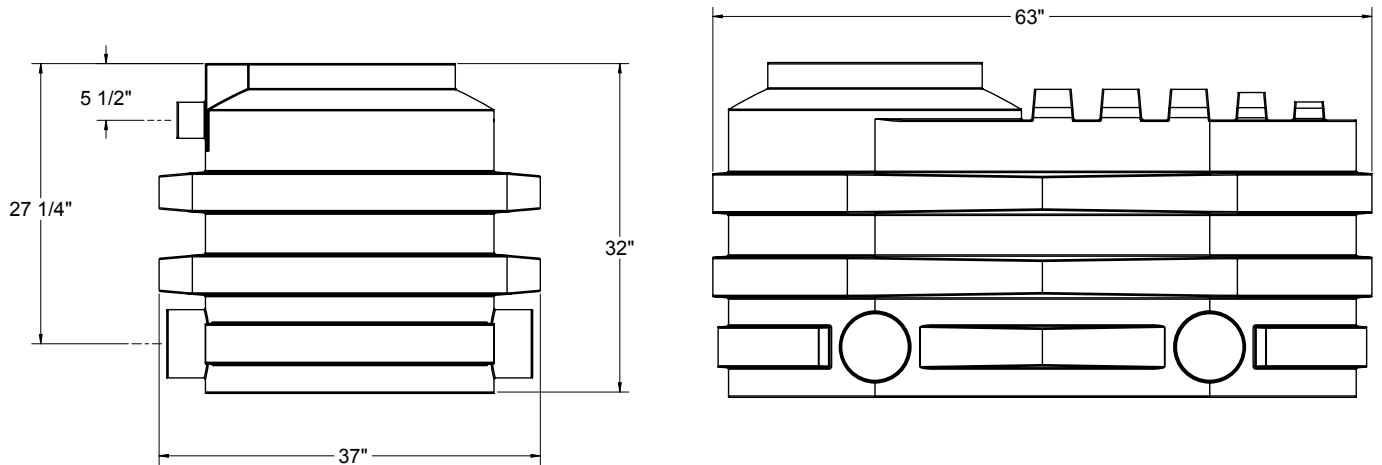

LIMITED TRADE WARRANTY

The Filtrific Co. LLC (Filtrific) offers a 5 year warranty on all Flotender polyethylene components. All other products and accessory components are warranted to be free of defects in material and workmanship for a period of one (1) year from the original date of purchase. This warranty extends only to the original installer of the Flotender system. Filtrific will repair or replace any properly handled and installed product which fails under normal operating conditions within the warranty period, providing it was installed and maintained correctly, and all materials are returned to the factory (shipping prepaid). This warranty does not extend to labor or replacement charges, nor does it apply to any equipment of another manufacturer used in conjunction with Flotender products. Filtrific shall not be held liable for indirect, incidental, or consequential damages to Flotender products.



Flotender by Filtrific®
15500 Woodinville-Redmond Road
Suite C-100 Woodinville, WA 98072
P: 800.906.0604 • F: 425.482.9559

www.flotender.com

Copyright 2011 by Filtrific® Company LLC. Printed in U.S.A.
Certain products illustrated in this catalog are protected by
applicable patents and patents pending. Filtrific® will aggressively
defend all of its intellectual property.

AVAILABLE FROM:

